

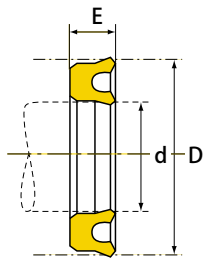

CATALOGUE OF SEALS FOR SLIDING SHAFTS

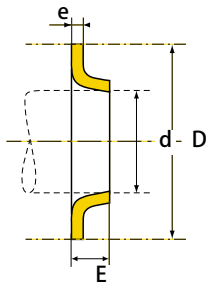

Type DL



Type LIO

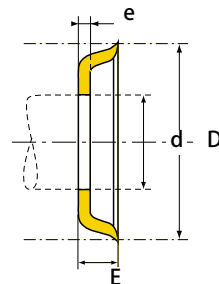

Type LEO

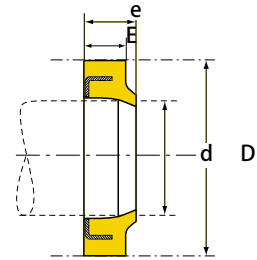

Type DRT

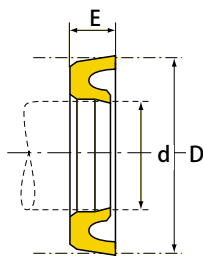

Type DLI

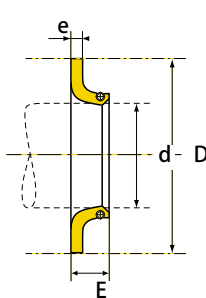

Type LIR

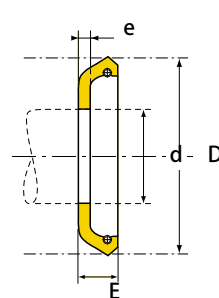

Type LER

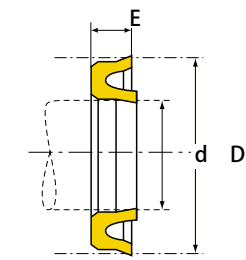

Type DLE / DLES

- Width of the groove : $E + 1$ mm (for DL).
- Operating parameters :
 Maximum admissible pressure : 150 bars (for DL) ; 30 bars (for LIO, LEO).
 Linear speed admissible : up to 0.3 m/sec depending on the operating conditions.

d (mm)	D (mm)	E (mm)	Type	Elastomer	Reference
4	14	12	DL	NBR	710093
6	14	11,5	DL	NBR	710620
	32	10	LEO	NBR	714057
8	14	3,5x5	DRT	NBR	711700
	14	4	DLI	NBR	716501
	17,9	5,5x1,5	LEO	NBR	714432
9	20	4	DLS	NBR	710678
10	16	3,5x5	DRT	NBR	711701
	17,9	5,5	LEO	NBR	714045
	20	7	DLP	NBR	711001
11	28	7x2,5	LIO	NBR	712094
	36	12	LEO	NBR	714020
12	18	3,5x5	DRT	NBR	711702
	22	55	DLS	NBR	710679
	22	5x1,5	DLI	NBR	716502
	22	6,5	LIO	NBR	712350
	25	6,5	DLS	NBR	710233
13	21	5x2	LIO	NBR	712414
	20	3,5x5	DRT	NBR	711703

The part numbers indicated in bold type are kept in stock.

d (mm)	D (mm)	E (mm)	Type	Elastomer	Reference
14	26	8	LIR	NBR	713653
	38,1	10	DL	NBR	710132
15	21	3,5x5	DRT	NBR	711704
	25	8	DLT	NBR	711404
	25	10x3	LEO	NBR	714178
16	30	10x3	LEO	NBR	714179
	22	3,5x5	DRT	NBR	711705
	24	9	DL	NBR	710129
	25	6,5	DLE	NBR	716506
	26	8	DLT	NBR	711405
	28	9,6	DL	NBR	710218
	35	10	LER	NBR	715402
18	35	10x3	LEO	NBR	714418
	36	8x2,5	LIO	NBR	712095
	38	12	LEO	NBR	714442
	40	10	DL	NBR	710343
	40	12x3	LEO	NBR	714864
	28	5x7	DRT	NBR	711706
	30	8	DLES	NBR	716531
	30	10	DL	NBR	710290
	32,9	7,2	DL	NBR	710431
	36	6x2	LEO	NBR	714006
36	7x2,5	LIO	NBR	712005	
	10	LIR	NBR	713613	

Abbreviations : NBR = Nitrile; FKM = Fluorocarbon

DIMENSIONS

d (mm)	D (mm)	E (mm)	Type	Elastomer	Reference
	45	6x2	LEO	NBR	714645
	52	8x2	LEO	NBR	714013
	55	10x3	LEO	NBR	714471
	37	12	LEO	NBR	714817
	49	10,5	LEO	NBR	714486
	28	4,8	DL	NBR	710777
	30	5	DLI	NBR	716503
	30	5x7	DRT	NBR	711707
	30	8	DLT	NBR	711407
	32	8	DL	NBR	710555
	35	6,5	DLS	NBR	710091
	35	12	DL	NBR	710795
	40	8x3	LIO	NBR	712572
	40	12	DL	NBR	710111
	65	10x3	LEO	NBR	714472
	40	12	DL	NBR	710023
	45	12	DL	NBR	710344
	32	5x7	DRT	NBR	711708
	32	7	DLP	NBR	711004
	32	8	DLT	NBR	711408
	32	12	DLES	NBR	716588
	40	12	DL	NBR	710527
	44	10x4	LIO	NBR	712533
	38	6x2,5	LIO	NBR	712701
	38	10	LIR	NBR	713702
	36	8x2,5	LIO	NBR	712348
	36	9,6	DL	NBR	710289
	25	8x2,5	LIO	NBR	712012
	40	9	DLP	NBR	711005
	45	11	DL	NBR	710061
	49	10,8	DL	NBR	710060
	35	5x7	DRT	NBR	711709
	60	10x5	LEO	NBR	714110
	38,1	8	DLE	NBR	716560
	41	8,4	DL	NBR	710144
	40	10	DLE	NBR	716507
	38	5x7	DRT	NBR	711710
	46	10	DL	NBR	710528
	47,5	4x3	LEO	NBR	714047
	49	13x4	LIO	NBR	712534
	41	10	DL	NBR	710570
	40	5x7	DRT	NBR	711711
	40	12	DLES	NBR	716589
	42	8x2,5	LIO	NBR	712092
	45	8	DLI	NBR	716629
	46	12	DL	NBR	710433
	48	10	DLES	NBR	716532
	95	14x4	LEO	NBR	714539
	42	5x7	DRT	NBR	711712
	47	10	DLT	NBR	711412
	50	9x3	LIO	NBR	712535
	50	12	DL	NBR	710470
	44	12	DLES	NBR	716596
	50	14,4	DL	NBR	710073
	52	12x3,5	LIO	NBR	712694
	45	7x10	DRT	NBR	711713
	50	9	DLP	NBR	711006
	51	9,6	DL	NBR	710354
	46	5x7	DRT	NBR	711714
	50	8	DLI	NBR	716536
	55	12	DL	NBR	710490
	60	10x4	LIO	NBR	712492
	50	5	DL	NBR	710190
	50	5x8	DRT	NBR	711715
	55	10	DLT	NBR	711415

d (mm)	D (mm)	E (mm)	Type	Elastomer	Reference	
	40	62	14,5	DL	NBR	710489
		65	10x5	LIO	NBR	712491
	42	52	5x7	DRT	NBR	711716
		52	12	DLES	NBR	716590
	45	55	5x7	DRT	NBR	711717
		63	12	DL	NBR	710529
		74	17x5	LIO	NBR	712737
	48	63	9	DLP	NBR	711008
		63,5	10	DLE	NBR	716561
		65	3,5x5	LEOS	NBR	714093
	50	56	5x7	DRT	NBR	711746
		60	5x7	DRT	NBR	711718
		65	7x10	DRT	NBR	711745
		65	10	DLT	NBR	711417
		70	10x3	LIO	NBR	712571
		70	12	DL	NBR	710530
		74	15	DL	NBR	710078
		76	17	DL	NBR	710056
	50,5	66,5	12	DL	NBR	710196
	52	68	10	LIR	NBR	713809
	55	63	7x10	DRT	NBR	711747
		65	12	DLES	NBR	716591
		71	12	DL	NBR	710629
		75	10	DLS	NBR	710057
	56	66	5x7	DRT	NBR	711720
		72	12	DLES	NBR	716533
		80	12x3	LIO	NBR	712475
		80	14,5	DL	NBR	710474
	57	73	9,6	DL	NBR	710086
	58	78	10	DLS	NBR	710058
	60	70	5x7	DRT	NBR	711721
		80	10	DL	NBR	710423
		80	12	LIR	NBR	713611
		85	7x2,5	LEO	NBR	714421
		89,5	20x5	LIO	NBR	712823
	62	85	12x3	LIO	NBR	712131
	63	73	5x7	DRT	NBR	711722
		93	18	DL	NBR	710531
	63,5	203,2	28,5x8,7	LEO	NBR	714497
	64	80	12	DL	NBR	710434
		82,5	13	DLE	NBR	716562
	65	75	5x7	DRT	NBR	711723
		83	12	DL	NBR	710729
		90	10	LER	NBR	715403
		90	10x5	LIO	NBR	712624
	70	80	5x7	DRT	NBR	711724
		80	12	DLES	NBR	716592
		86	12	DL	NBR	710635
		95	15	DL	NBR	710025
	75	83	7x10	DRT	NBR	711725
		91	12	DL	NBR	710413
		100	10x3	LIO	NBR	712022
	76,2	107,8	26,5	DL	NBR	710569
	78	94	12	DL	NBR	710632
	80	88	7x10	DRT	NBR	711726
		90	7x10	DRT	NBR	711744
		94	9	DLE	NBR	716335
		100	12	DLT	NBR	711425
		100	17	DL	NBR	710169
		117	14	LIR	NBR	713796

The part numbers indicated in bold type are kept in stock.

Abbreviations : NBR = Nitrile; FKM = Fluorocarbon

DIMENSIONS

d (mm)	D (mm)	E (mm)	Type	Elastomer	Reference
85	95 103	7x10 13x3	DRT LIO	NBR NBR	711743 712981
86	117	14	LIR	NBR	713740
88	110	8x3,5	LIO	NBR	712430
90	130	10x4	LIO	NBR	712821
92	112	12,6	DL	NBR	710068
94	112	12	DL	NBR	710079
98	114	12	DL	NBR	710724
100	110 116	7x10 7	DRT LER	NBR NBR	711728 715666
104	120	11	DLE	NBR	716549
106	122	12	DL	NBR	710805

The part numbers indicated in bold type are kept in stock.

d (mm)	D (mm)	E (mm)	Type	Elastomer	Reference
110	120 126	7x10 7	DRT LER	NBR NBR	711729 715667
115	130,2	6,5	LEOS	NBR	714008
116	202	20	LEOS	NBR	714004
120	136	7	LER	NBR	715668
125	140	9x12	DRT	NBR	711735
130	160	18	DLP	NBR	711013
140	160 160 170	18 18 18	DL DL DLT	NBR NBR NBR	710002 710047 711433
150	209	25	LEO	NBR	714781
196	228	24	DL	NBR	710001
196,3	232	21	DL	NBR	710004
278	304,8	24	DL	NBR	710564

Abreviations : NBR = Nitrile; FKM = Fluorocarbon