



SP550W, 551W, 552W, 553W SP560W, 561W, 562W, 563W

Fréquence propre : (1)
15 à 20 Hz

DESCRIPTION

Machine mount available with a stud (SP55*W) or threaded hole (SP56*W).

- Top cup and stud are mild steel zinc plated.
- Stainless steel wire mesh cushion.
- Natural frequency between 15 to 20 Hz.

APPLICATIONS

- Mount for low loads.
- Suitable for rotating machines (> 2500 rpm) and laboratory equipment ...

OPERATING CHARACTERISTICS

Reference with thread stud	Reference with tapped hole	$\varphi D1$ (mm)	$\varphi D2$ (mm)	H (mm)	h * (mm)	G	Static load (daN)	Deflection under load (mm)
SP550W	SP560W	28	23,6	17,5	20	M6	60	4,2
SP551W	SP561W	40	34,5	17	20	M6	100	4,8
SP552W	SP562W	45	40	22	25	M8	150	5,6
SP553W	SP563W	58	53,6	22	25	M8	225	6,3

* SP55*W only.

SP55*W

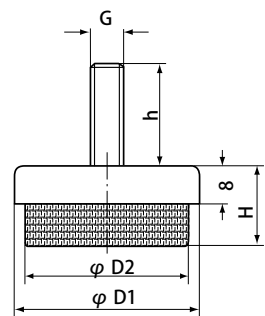

SP56*W

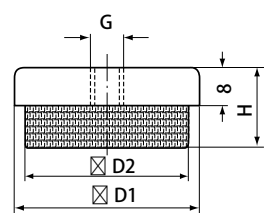

(1) Natural frequencies with max/min loads, see : OPERATING CHARACTERISTICS.